

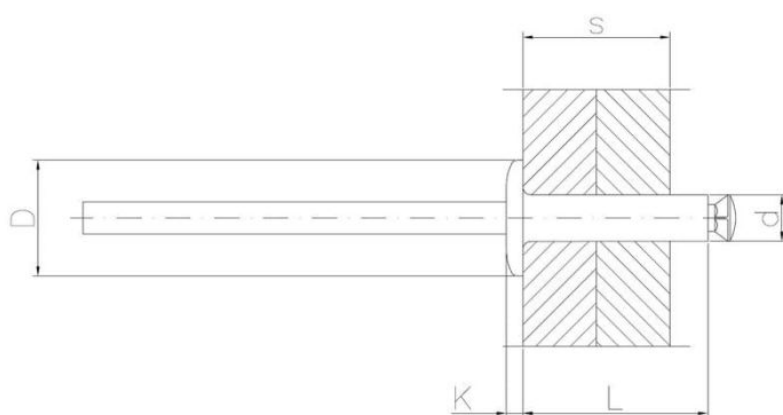

Pinnoite tyyppi:



Dimensions

Material index	d [mm]	L [mm]	D [mm]	s [mm]	k [mm]
2410048180AST	4.8	18	10.0	8.0-12.0	2.0
2410040160AST	4.0	16	8.0	6.0-9.0	1.7
2410048160AST	4.8	16	10.0	5.0-8.5	2.0
2410040120AST	4.0	12	8.0	4.0-6.5	1.7
2410048240AST	4.8	24	10.0	16.0-19.0	2.0
2410040200AST	4.0	20	8.0	12.0-15.0	1.7
2410048210AST	4.8	21	10.0	11.0-15.0	2.0
2410040100AST	4.0	10	8.0	1.5-5.0	1.7