

Pinnoite tyyppi:

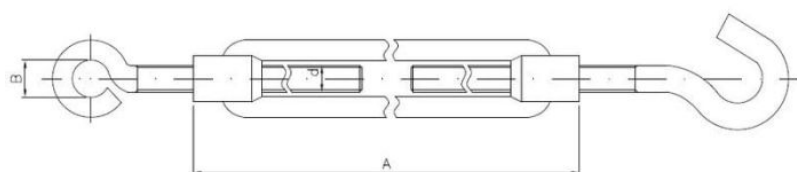

Dimensions

Material index	d	A [mm]	B [mm]	Kuormitettavuus [kg]
6310080110S	M8	110	12	100
6310080070S	M8	70	12	100
6310060060S	M6	60	10	50
6310060100S	M6	100	10	50
6310060110S	M6	110	12	50
6310050050S	M5	50	8	30
6310120130S	M12	130	15	200
6310100120S	M10	120	13	150