

Pinnoite tyyppi:

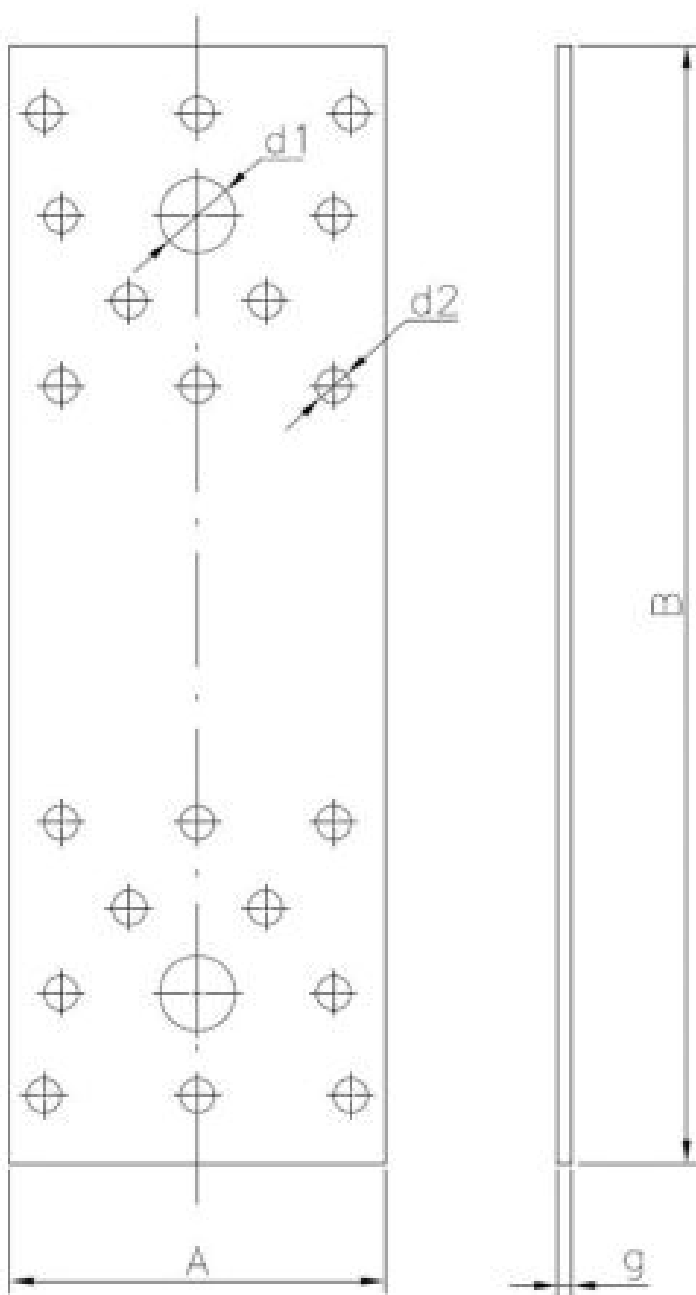

B
POWŁOKA
CYNKOWA
BIAŁA



Dimensions

Material index	Oznaczenie	A [mm]	B [mm]	d1 [mm]	d2 [mm]
6204LP01100035S	LP1	35	100	8 x Ø5	8 x Ø11

Material index	Oznaczenie	A [mm]	B [mm]	d1 [mm]	d2 [mm]
6204LP04280055S	LP4	55	280	40 x Ø5	2 x Ø11
6204LP06210090S	LP6	90	210	36 x Ø5	2 x Ø14
6204LP02140055S	LP2	55	140	20 x Ø5	2 x Ø11
6204LP05180065S	LP5	65	180	16 x Ø5	2 x Ø11
6204LP03200035S	LP3	35	200	16 x Ø5	4 x Ø11