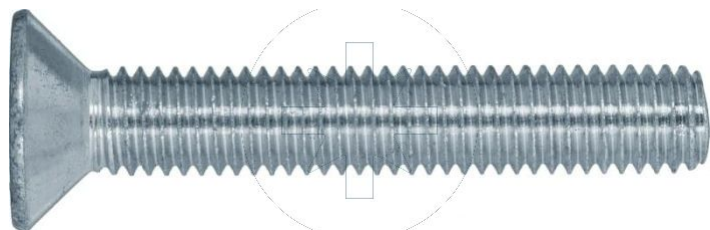

SEND THE INQUIRY

+358 103 195 100

## Standards:

DIN 7991  
ISO 10642

Luokka:

10.9

Pinnoite tyyppi:

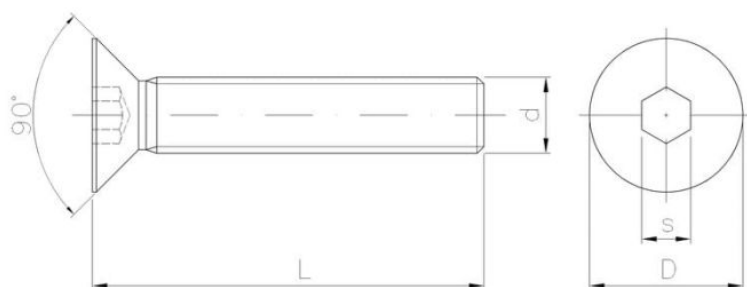

## Dimensions

| Material index   | d   | L [mm] | D [mm] | Gwint      | Mekaaninen luokitus | Pinnoite tyyppi         | Yksikkö |
|------------------|-----|--------|--------|------------|---------------------|-------------------------|---------|
| 1338040020IMB10T | M4  | 20     | 8.0    | Na calosci | 10.9                | B - ocynk biały         | TYS     |
| 1338040010IMO10T | M4  | 10     | 8.0    | Na calosci | 10.9                | OX - powłoka oksydowana | TYS     |
| 1338040012IMB10T | M4  | 12     | 8.0    | Na calosci | 10.9                | B - ocynk biały         | TYS     |
| 1338040010IMB10T | M4  | 10     | 8.0    | Na calosci | 10.9                | B - ocynk biały         | TYS     |
| 1338040016IMB10T | M4  | 16     | 8.0    | Na calosci | 10.9                | B - ocynk biały         | TYS     |
| 1338040008IMB10T | M4  | 8      | 8.0    | Na calosci | 10.9                | B - ocynk biały         | TYS     |
| 1338040012IMO10T | M4  | 12     | 8.0    | Na calosci | 10.9                | OX - powłoka oksydowana | TYS     |
| 1338040025IMB10T | M4  | 25     | 8.0    | Na calosci | 10.9                | B - ocynk biały         | TYS     |
| 1338040008IMO10T | M4  | 8      | 8.0    | Na calosci | 10.9                | OX - powłoka oksydowana | TYS     |
| 1338120030IMB10T | M12 | 30     | 24.0   | Na calosci | 10.9                | B - ocynk biały         | TYS     |
| 1338120020IMB10T | M12 | 20     | 24.0   | Na calosci | 10.9                | B - ocynk biały         | TYS     |
| 1338120040IMB10S | M12 | 40     | 24.0   | Na calosci | 10.9                | B - ocynk biały         | SZT     |
| 1338120035IMB10S | M12 | 35     | 24.0   | Na calosci | 10.9                | B - ocynk biały         | SZT     |
| 1338120025IMB10S | M12 | 25     | 24.0   | Na calosci | 10.9                | B - ocynk biały         | SZT     |
| 1338120050IMB10S | M12 | 50     | 24.0   | Na calosci | 10.9                | B - ocynk biały         | SZT     |
| 1338100060IMB10T | M10 | 60     | 20.0   | Na czesci  | 10.9                | B - ocynk biały         | TYS     |
| 1338100050IMB10T | M10 | 50     | 20.0   | Na czesci  | 10.9                | B - ocynk biały         | TYS     |
| 1338100030IMB10T | M10 | 30     | 20.0   | Na calosci | 10.9                | B - ocynk biały         | TYS     |

| Material index   | d   | L [mm] | D [mm] | Gwint      | Mekaaninen luokitus | Pinoite tyyppi          | Yksikkö |
|------------------|-----|--------|--------|------------|---------------------|-------------------------|---------|
| 1338100035IMB10T | M10 | 35     | 20.0   | Na calosci | 10.9                | B - ocynk biały         | TYS     |
| 1338100080IMB10T | M10 | 80     | 20.0   | Na czesci  | 10.9                | B - ocynk biały         | TYS     |
| 1338100025IMB10T | M10 | 25     | 20.0   | Na calosci | 10.9                | B - ocynk biały         | TYS     |
| 1338100016IMB10T | M10 | 16     | 20.0   | Na calosci | 10.9                | B - ocynk biały         | TYS     |
| 1338100020IMB10T | M10 | 20     | 20.0   | Na calosci | 10.9                | B - ocynk biały         | TYS     |
| 1338100045IMB10T | M10 | 45     | 20.0   | Na czesci  | 10.9                | B - ocynk biały         | TYS     |
| 1338100040IMB10T | M10 | 40     | 20.0   | Na czesci  | 10.9                | B - ocynk biały         | TYS     |
| 1338080045IMB10T | M8  | 45     | 16.0   | Na czesci  | 10.9                | B - ocynk biały         | TYS     |
| 1338080020IMB88T | M8  | 20     | 16.0   | Na calosci | 10.9                | B - ocynk biały         | TYS     |
| 1338080060IMB10T | M8  | 60     | 16.0   | Na czesci  | 10.9                | B - ocynk biały         | TYS     |
| 1338080035IMO10T | M8  | 35     | 16.0   | Na calosci | 10.9                | OX - powłoka oksydowana | TYS     |
| 1338080030IMB10T | M8  | 30     | 16.0   | Na calosci | 10.9                | B - ocynk biały         | TYS     |
| 1338080025IMO10T | M8  | 25     | 16.0   | Na calosci | 10.9                | OX - powłoka oksydowana | TYS     |
| 1338080040IMB10T | M8  | 40     | 16.0   | Na czesci  | 10.9                | B - ocynk biały         | TYS     |
| 1338080050IMB10T | M8  | 50     | 16.0   | Na czesci  | 10.9                | B - ocynk biały         | TYS     |
| 1338080020IMO10T | M8  | 20     | 16.0   | Na calosci | 10.9                | OX - powłoka oksydowana | TYS     |
| 1338080040IMO10T | M8  | 40     | 16.0   | Na czesci  | 10.9                | OX - powłoka oksydowana | TYS     |
| 1338080025IMB10T | M8  | 25     | 16.0   | Na calosci | 10.9                | B - ocynk biały         | TYS     |
| 1338080012IMB10T | M8  | 12     | 16.0   | Na calosci | 10.9                | B - ocynk biały         | TYS     |
| 1338080030IMO10T | M8  | 30     | 16.0   | Na calosci | 10.9                | OX - powłoka oksydowana | TYS     |
| 1338080016IMB10T | M8  | 16     | 16.0   | Na calosci | 10.9                | B - ocynk biały         | TYS     |
| 1338080035IMB10T | M8  | 35     | 16.0   | Na calosci | 10.9                | B - ocynk biały         | TYS     |
| 1338080020IMB10T | M8  | 20     | 16.0   | Na calosci | 10.9                | B - ocynk biały         | TYS     |
| 1338080010IMB10T | M8  | 10     | 16.0   | Na calosci | 10.9                | B - ocynk biały         | TYS     |
| 1338060035IMB10T | M6  | 35     | 11.8   | Na calosci | 10.9                | B - ocynk biały         | TYS     |
| 1338060020IMO10T | M6  | 20     | 11.8   | Na calosci | 10.9                | OX - powłoka oksydowana | TYS     |
| 1338060040IMB10T | M6  | 40     | 11.8   | Na calosci | 10.9                | B - ocynk biały         | TYS     |
| 1338060055IMB10T | M6  | 55     | 11.8   | Na czesci  | 10.9                | B - ocynk biały         | TYS     |
| 1338060055IMB88T | M6  | 55     | 11.8   | Na czesci  | 10.9                | B - ocynk biały         | TYS     |
| 1338060060IMB10T | M6  | 60     | 11.8   | Na czesci  | 10.9                | B - ocynk biały         | TYS     |
| 1338060030IMB10T | M6  | 25     | 11.8   | Na calosci | 10.9                | B - ocynk biały         | TYS     |
| 1338060100IMB10T | M6  | 100    | 11.8   | Na czesci  | 10.9                | B - ocynk biały         | TYS     |
| 1338060016IMO10T | M6  | 16     | 11.8   | Na calosci | 10.9                | OX - powłoka oksydowana | TYS     |
| 1338060020IMB10T | M6  | 20     | 11.8   | Na calosci | 10.9                | B - ocynk biały         | TYS     |
| 1338060016IMB10T | M6  | 16     | 11.8   | Na calosci | 10.9                | B - ocynk biały         | TYS     |
| 1338060025IMO10T | M6  | 25     | 11.8   | Na calosci | 10.9                | OX - powłoka oksydowana | TYS     |
| 1338060040IMO10T | M6  | 40     | 11.8   | Na calosci | 10.9                | OX - powłoka oksydowana | TYS     |
| 1338060050IMB10T | M6  | 50     | 11.8   | Na czesci  | 10.9                | B - ocynk biały         | TYS     |
| 1338060012IMB10T | M6  | 12     | 11.8   | Na calosci | 10.9                | B - ocynk biały         | TYS     |

| Material index   | d  | L [mm] | D [mm] | Gwint      | Mekaaninen luokitus | Pinnoite tyyppi         | Yksikkö |
|------------------|----|--------|--------|------------|---------------------|-------------------------|---------|
| 1338060008IMB10T | M6 | 8      | 11.8   | Na calosci | 10.9                | B - ocynk biały         | TYS     |
| 1338060025IMB10T | M6 | 25     | 11.8   | Na calosci | 10.9                | B - ocynk biały         | TYS     |
| 1338060030IMO10T | M6 | 30     | 11.8   | Na calosci | 10.9                | OX - powłoka oksydowana | TYS     |
| 1338060070IMB10T | M6 | 70     | 11.8   | Na czesci  | 10.9                | B - ocynk biały         | TYS     |
| 1338050040IMB10T | M5 | 40     | 10.0   | Na czesci  | 10.9                | B - ocynk biały         | TYS     |
| 1338050016IMB10T | M5 | 16     | 10.0   | Na calosci | 10.9                | B - ocynk biały         | TYS     |
| 1338050030IMB10T | M5 | 30     | 10.0   | Na calosci | 10.9                | B - ocynk biały         | TYS     |
| 1338050012IMB10T | M5 | 12     | 10.0   | Na calosci | 10.9                | B - ocynk biały         | TYS     |
| 1338050016IMO10T | M5 | 16     | 10.0   | Na calosci | 10.9                | OX - powłoka oksydowana | TYS     |
| 1338050010IMB10T | M5 | 10     | 10.0   | Na calosci | 10.9                | B - ocynk biały         | TYS     |
| 1338050020IMB10T | M5 | 20     | 10.0   | Na calosci | 10.9                | B - ocynk biały         | TYS     |
| 1338050020IMO10T | M5 | 20     | 10.0   | Na calosci | 10.9                | OX - powłoka oksydowana | TYS     |
| 1338050008IMS10T | M5 | 8      | 10.0   | Na calosci | 10.9                | S - surowy              | TYS     |
| 1338050035IMB10T | M5 | 35     | 10.0   | Na czesci  | 10.9                | B - ocynk biały         | TYS     |
| 1338050010IMO10T | M5 | 10     | 10.0   | Na calosci | 10.9                | OX - powłoka oksydowana | TYS     |
| 1338050025IMB10T | M5 | 25     | 10.0   | Na calosci | 10.9                | B - ocynk biały         | TYS     |